



KLEEpump

KSP series

KLEEpump KSP is a small, efficient, high-quality construction pump. Resistant to sand, mud and gravel. Can be supplied with bottom suction that can pump down to 3 mm. Available in 1- and 3-phase with or without automatic. Power from 0.4 to 0.75 kW.

The KLEEpump series is our own high-quality brand, and has been developed and tested in collaboration with our manufacturer.

See more at www.klee.dk for our selection of drain and sewage pumps.

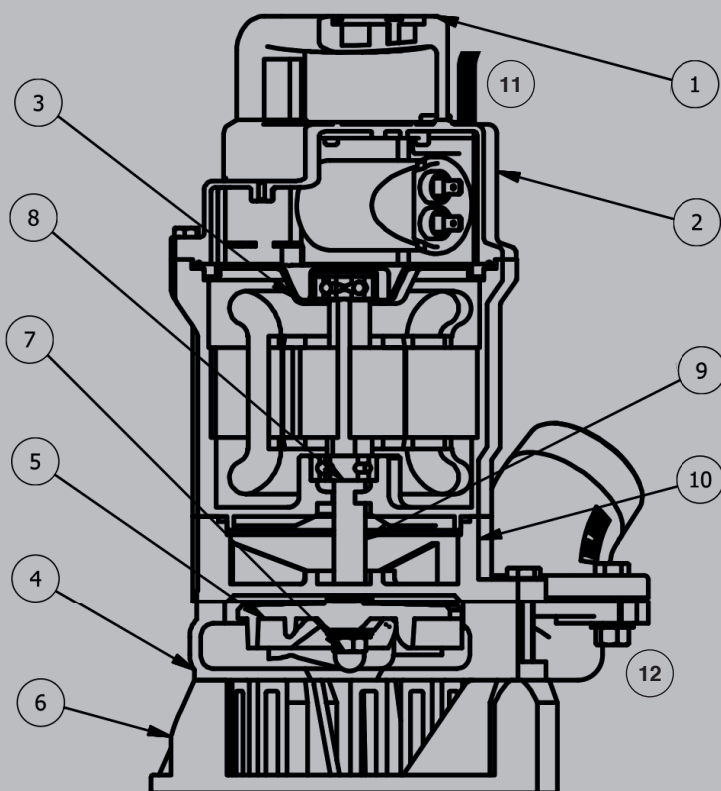

Component

1. Handle (Nylon)
2. Motor Cover
3. Fittings
4. Pump Casing (FC 200)
5. Impeller
6. Strainer
7. Agitator
8. Gasket (shaft seal) (SiC/SiC)
9. Shaft (SUS 410)
10. Motor Casing
11. Cable (H07RN-F)
12. Various screws & bolts (AISI 304)



Model codes

KSP: Name of series
S: 1-phase (standard 1x230V)
T: 3-phase (standard 3x400V)
SAL: Vertical swimming switch
SA: Swimming switch

Motor data (KSP)

- Motor power: 0,4-0,75 kW
- Frequency: 50Hz
- Nominal Speed: 2900 rpm
- Protection Device:
Thermal Protector (1-phase)

Pump data (KSP)

- Impeller: Open Impeller
- Shaft Seal/Mechanical:
Double Seals
- Bearing: Closed Ball Bearing

Operation Conditions

Fluid Temperature:
0 to 40°C

Applications

- Construction need for drainage of surface water.
- Drainage with or without well (basements, residential areas, gardens).
- Waterfalls and fountains.
- Water from lakes and streams.
- Sludge Pumps in sumps.
- A pump for use in a pinch (low suction option).

Features

- Cables (10 m with Danish plug on 1-phase models)
- Impeller (Polyurethane suitable for sand and gravel)
- Switches (several types of automatics)
- Bottom strainer (can be replaced for a bottom suction with a working depth of 3 mm)
- Double mechanical SiC shaft seal (mounted in the oil chamber)
- Agitator (avoid clogging)
- Flanges and connections, etc.
- Pump houses

Accessories

- Hoses
- Storz couplings
- low suction



KLEEpump – KSP series

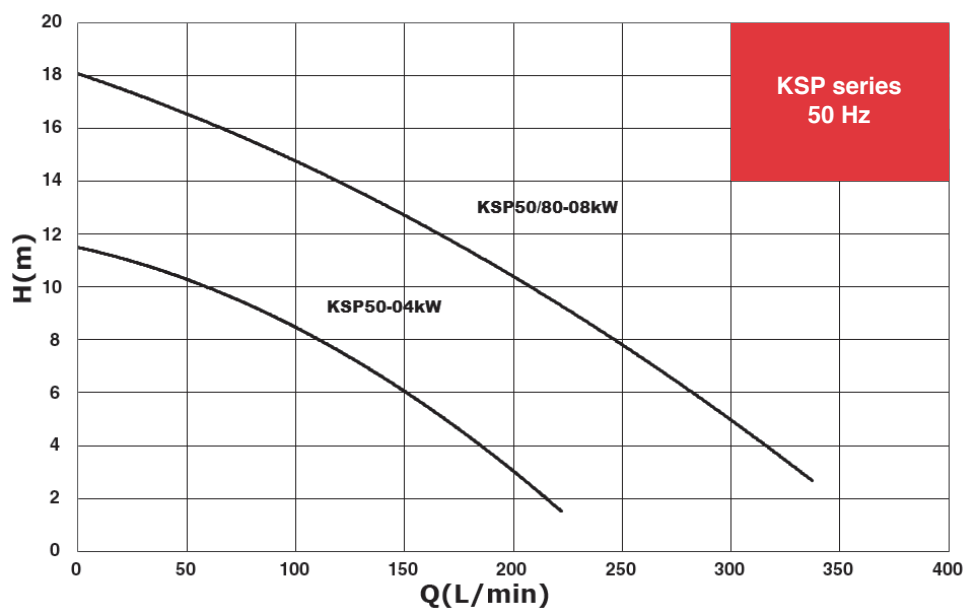

KSP S/T

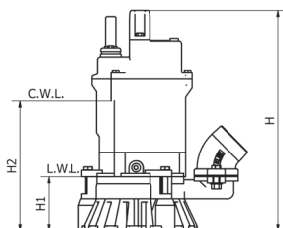

KSP SA

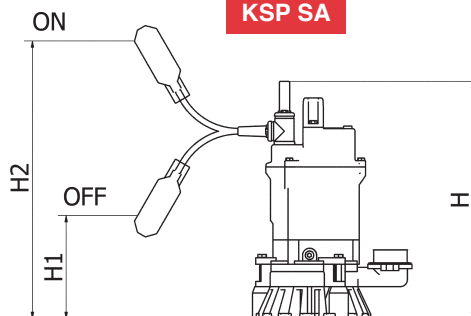

KSP SAL

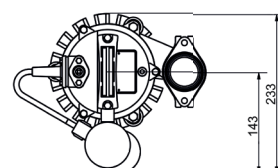
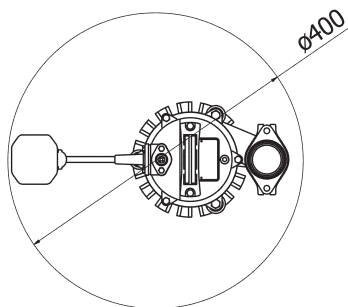
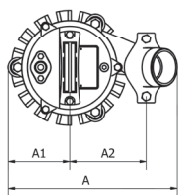
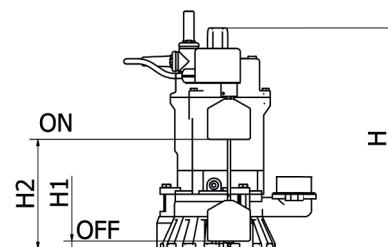

S= 1x230 (1-phase) / T= 3x400 (3-phase)

Technical data

Discharge [mm]	Model	Version	Power	Current		Dimensions [mm]						Weight
			kW	Ø (Phase)	V	A	A1	A2	H	H1	H2	Kg
50 (2")	KSP50-5-04-S/T	Manuel	0,4	1/3	1x230/3x400	262	95	120	347	90	200	12
	KSP50-5-04-SA	Automatic	0,4	1	230	262	95	120	347	115	475	12,3
	KSP50-5-04-SAL	Automatic	0,4	1	230	262	95	120	347	89	168	12,3
50/80 (2/3")	KSP50/80-5-08-S/T	Manuel	0,75	1/3	1x230/3x400	280	95	135	372	90	225	16
	KSP50/80-5-08-SA	Automatic	0,75	1	230	280	95	135	372	140	500	16,3
	KSP50/80-5-08-SAL	Automatic	0,75	1	230	280	95	135	372	90	193	16,3

All models are supplied with a hose connection except model 50-5-04-S which is supplied with a 45° bend.



See more at www.klee.dk

Retailer:

Brd. Klee A/S

Gadagervej 11
2620 Albertslund
Tel 43 86 83 33
Fax 43 86 83 88
klee@klee.dk
www.klee.dk